

# TRUMBULL PERCUSSION REGIONAL CONTEST INFORMATION SATURDAY, FEBRUARY 29, 2020

---



## LOCATION

TRUMBULL HIGH SCHOOL  
72 STROBEL ROAD  
TRUMBULL CT, 06611

---

## EMERGENCY CONTACTS (DAY OF SHOW ONLY)

CONTEST ADMINISTRATOR: Jason Parent - [Jason@wgi.org](mailto:Jason@wgi.org) - 630-709-1678  
EVENT PARTNER: Kelli Pollock - [kellipollock24@gmail.com](mailto:kellipollock24@gmail.com) - 973-476-3822

---

## JUDGE PANEL

Effect Music - Dave Carbone  
Effect Visual - Frank Miller  
Music - Lee Beddis  
Visual - Dave McCarthy  
T&P - Bob Molloy

---

## COMPETITIONSUITE DETAILS

ACCESSING YOUR GROUP - <https://help.competitionsuite.com/article/16-accessing-your-group>

ADDING YOUR STAFF - <https://help.competitionsuite.com/article/61-adding-staff-members>

ACCESSING COMMENTARY - <https://help.competitionsuite.com/article/17-accessing-commentary>

*Score Summary Sheets are also located in your CompetitionSuite account with your overall score.*

---

## ADDITIONAL REGIONAL INFO

PERCUSSION PRELIMS LOGISTICAL SCHEDULE - [HTTPS://BIT.LY/20zZYJ2](https://bit.ly/20zZYJ2)

PERCUSSION FINALS LOGISTICAL SCHEDULE - [HTTPS://BIT.LY/2v9M3ZN](https://bit.ly/2v9M3ZN)

REGIONAL REMINDERS - [HTTPS://WGI.ORG/WP-CONTENT/UPLOADS/2020/01/PERC.WINDSREGIONALREMINDERS.PDF](https://wgi.org/wp-content/uploads/2020/01/PERC.WINDSREGIONALREMINDERS.PDF)

Winter Guard International, Inc.

2405 Cross Pointe Drive, Miamisburg, OH 45342/ Phone: 937-247-5919/ Fax: 937-247-9212/ Email: [office@wgi.org](mailto:office@wgi.org) Web: <http://wgi.org>

# Trumbull High School WGI Percussion Traffic

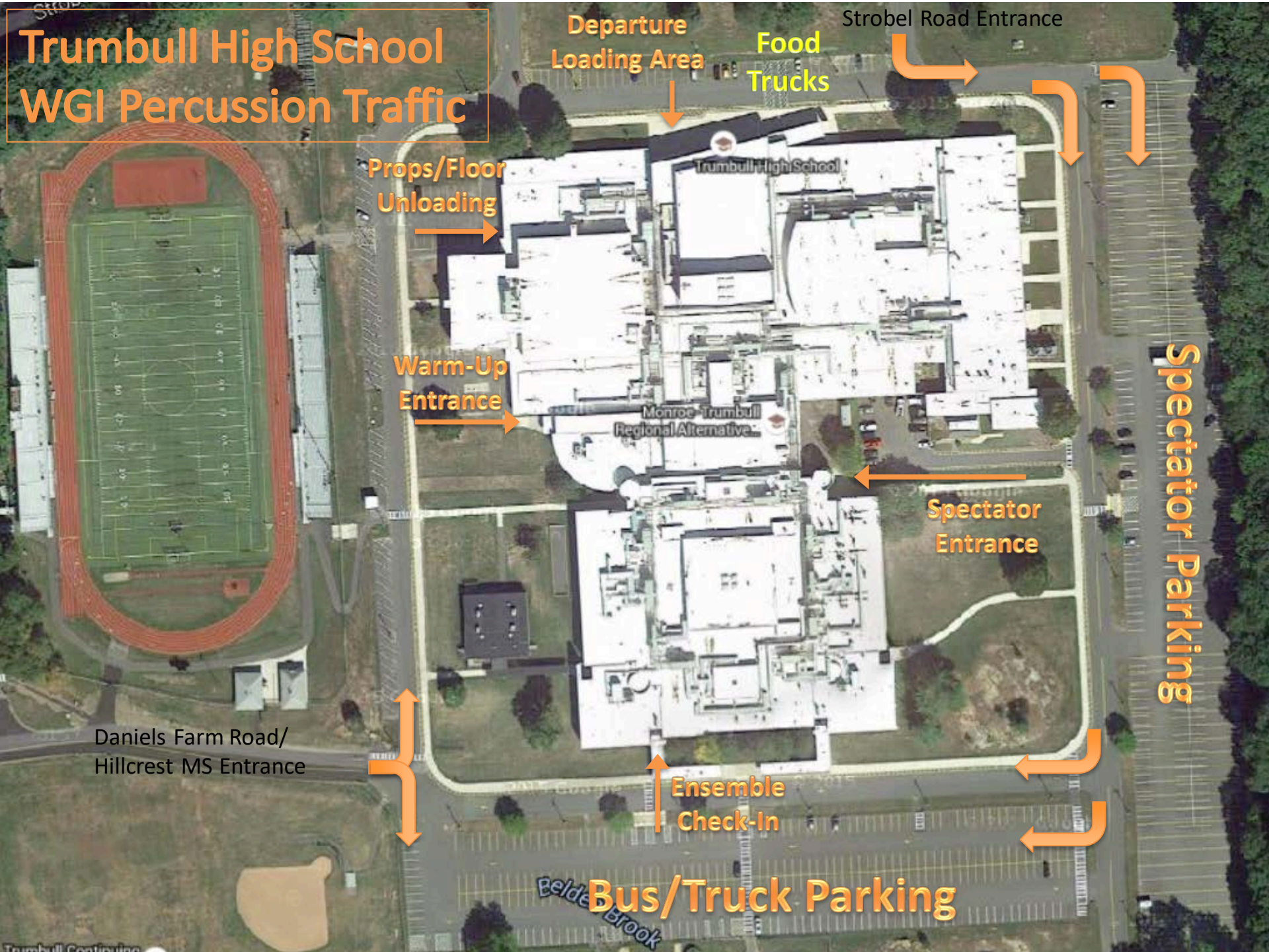

Departure  
Loading Area

Food  
Trucks

Strobel Road Entrance

Props/Floor  
Unloading

Warm-Up  
Entrance

Spectator  
Entrance

Speculator Parking

Daniels Farm Road/  
Hillcrest MS Entrance

Ensemble  
Check-In

Bus/Truck Parking

Belden Brook



# WGI Trumbull Regional Trumbull High School

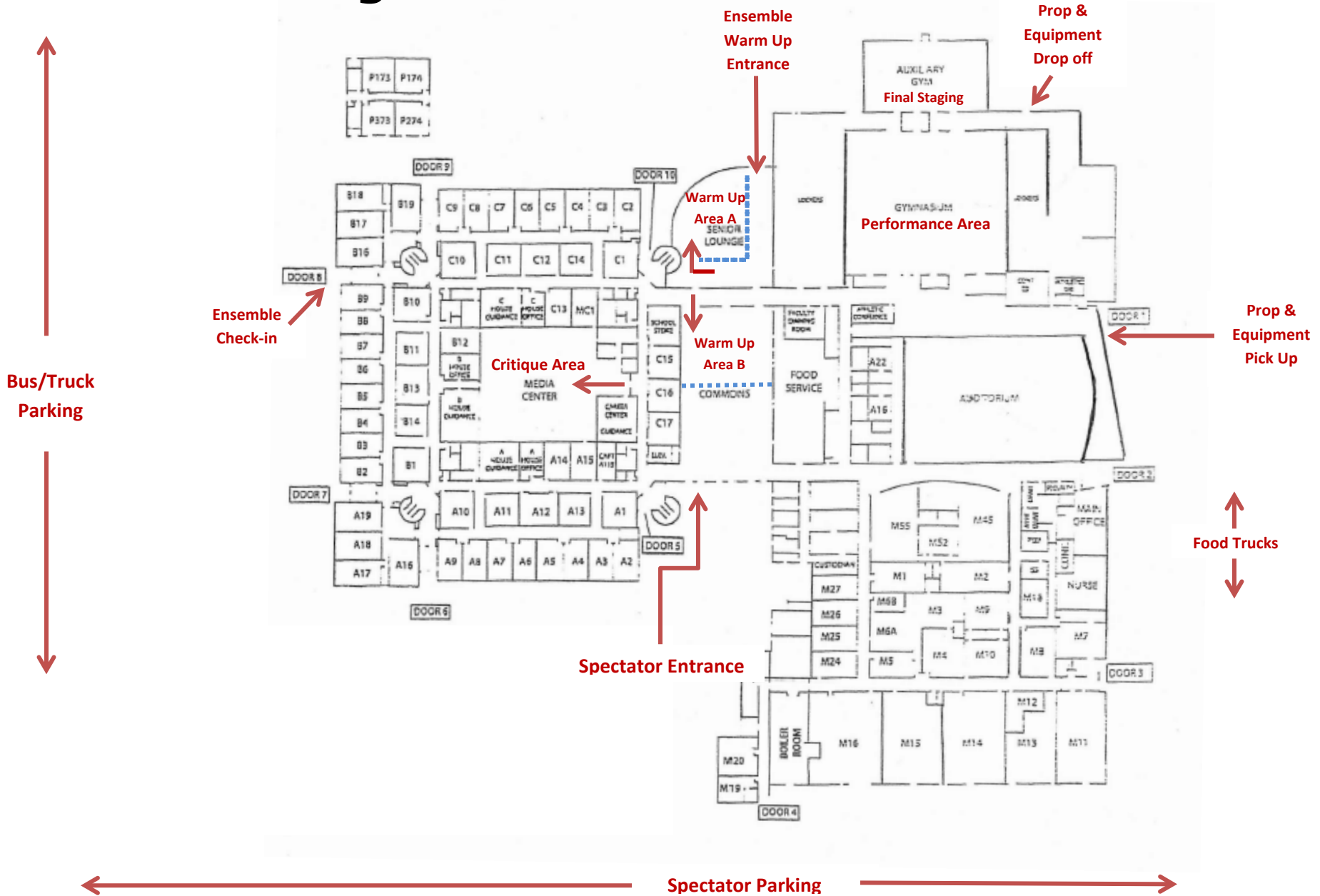



**Trumbull Regional Competition Area  
Trumbull High School, Trumbull, CT**

All WGI contest sites must have a minimum of seventy by one hundred feet (70' x 100') to accommodate a "safety zone" of five (5) feet from any spectator seating. If no spectators are seated on the left and right sides, then the safety zone will be eliminated on the left and right sides of the competition area and extend to the wall.

The "competition area" at this event measures 70'X106'. All performing groups must be prepared to perform within that area. Floors (tarps) may not extend into the safety zones per rules found in the WGI Adjudication Manual and Rulebook

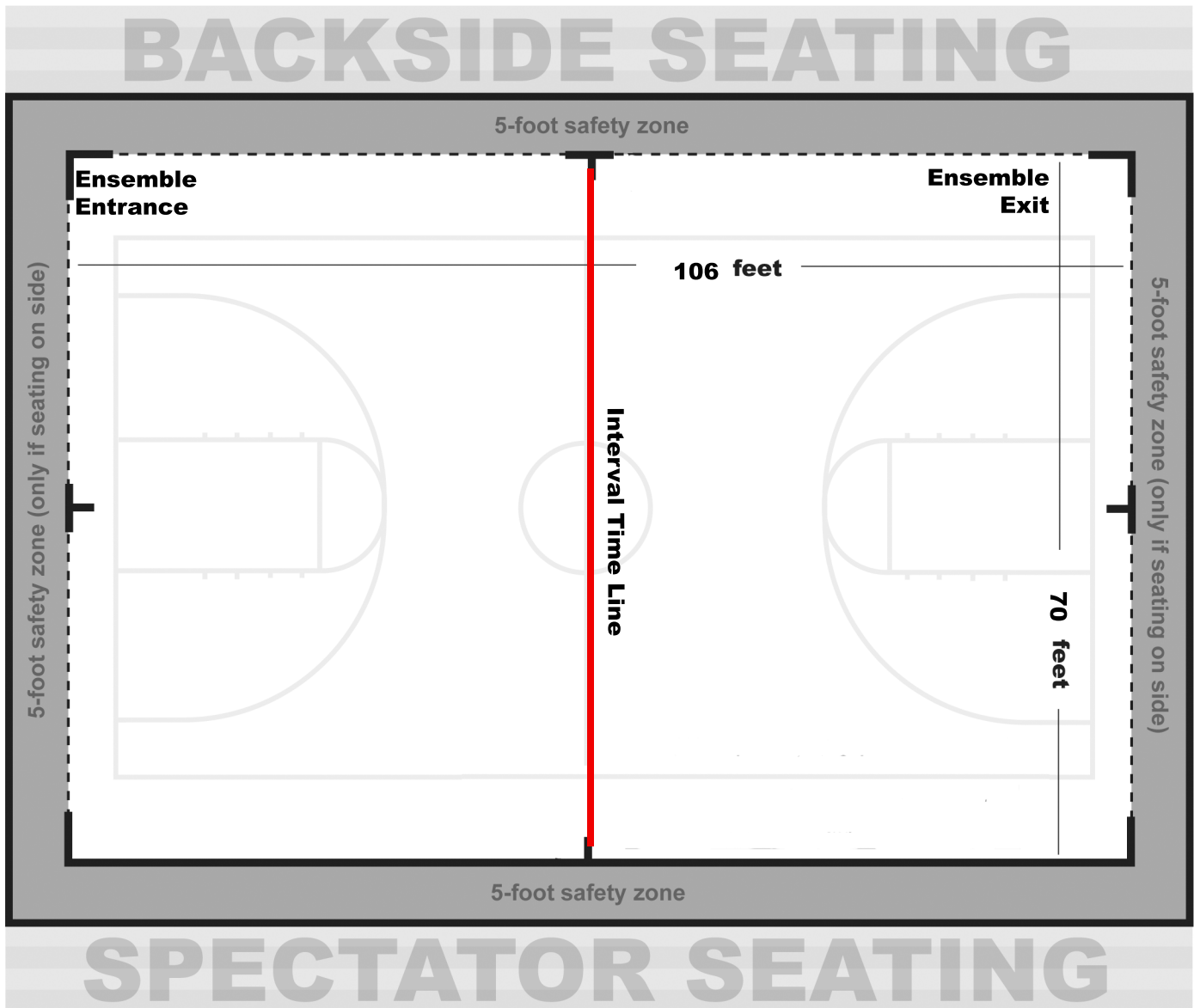

20 WGI  
20 I AM WGI



# JOIN THE TRUMBULL PERC/WINDS REGIONAL BAND!

## BAND

- Free all-in-one group communication platform.
- Share group announcements via push notification, text message or email.
- Robust group calendar and membership management.
- Customizable to your unique communication needs.
- Available for your mobile device and desktop.

## BAND LINK:

<https://band.us/n/aaac2fK8G9Bet>

- 1 Go to the Apple App Store or Google Play Store, search for BAND and download.
- 2 Sign up using your phone number, email, Facebook account or Google account.
- 3 Scan the QR code or use the link below to join the BAND.



#WGI2020

#IAMWGI