

RICHMOND PERCUSSION AND WINDS REGIONAL CONTEST INFORMATION

SATURDAY, FEBRUARY 29, 2020



LOCATION

POWHATAN HIGH SCHOOL
1800 JUDES FERRY ROAD
POWHATAN, VA 23139

EMERGENCY CONTACTS (DAY OF SHOW ONLY)

CONTEST ADMINISTRATOR: Dave Priester – dave@wgi.org - 703-587-9841
EVENT PARTNER: Neil Landini – neil.landini@powhatan.k12.va.us - 804- 986-4421

JUDGE PANEL

Effect Music– Ted Mascari
Effect Visual – Bobby Jones
Music – Tom Rarick
Visual – Jason Harvey
Winds Music Analysis – Beth Fabrizio
Winds Overall Effect – Doug Casteen
Winds Visual Analysis – Jeff Bridges
T&P – Jim Paxton

COMPETITIONSUITE DETAILS

ACCESSING YOUR GROUP - <https://help.competitionsuite.com/article/16-accessing-your-group>

ADDING YOUR STAFF - <https://help.competitionsuite.com/article/61-adding-staff-members>

ACCESSING COMMENTARY - <https://help.competitionsuite.com/article/17-accessing-commentary>

Score Summary Sheets are also located in your CompetitionSuite account with your overall score.

ADDITIONAL REGIONAL INFO

WINDS PRELIMS LOGISTICAL SCHEDULE - [HTTPS://BIT.LY/31B6rz0](https://bit.ly/31B6rz0)

PERCUSSION PRELIMS LOGISTICAL SCHEDULE - [HTTPS://BIT.LY/398Ng26](https://bit.ly/398Ng26)

WINDS FINALS LOGISTICAL SCHEDULE - [HTTPS://BIT.LY/31BNagE](https://bit.ly/31BNagE)

PERCUSSION FINALS LOGISTICAL SCHEDULE – [HTTPS://BIT.LY/2S9MbKv](https://bit.ly/2S9MbKv)

REGIONAL REMINDERS - [HTTPS://WGI.ORG/WP-CONTENT/UPLOADS/2020/01/PERC.WINDSREGIONALREMINDERS.PDF](https://wgi.org/wp-content/uploads/2020/01/PERC.WINDSREGIONALREMINDERS.PDF)

WGI Richmond Percussion Regional

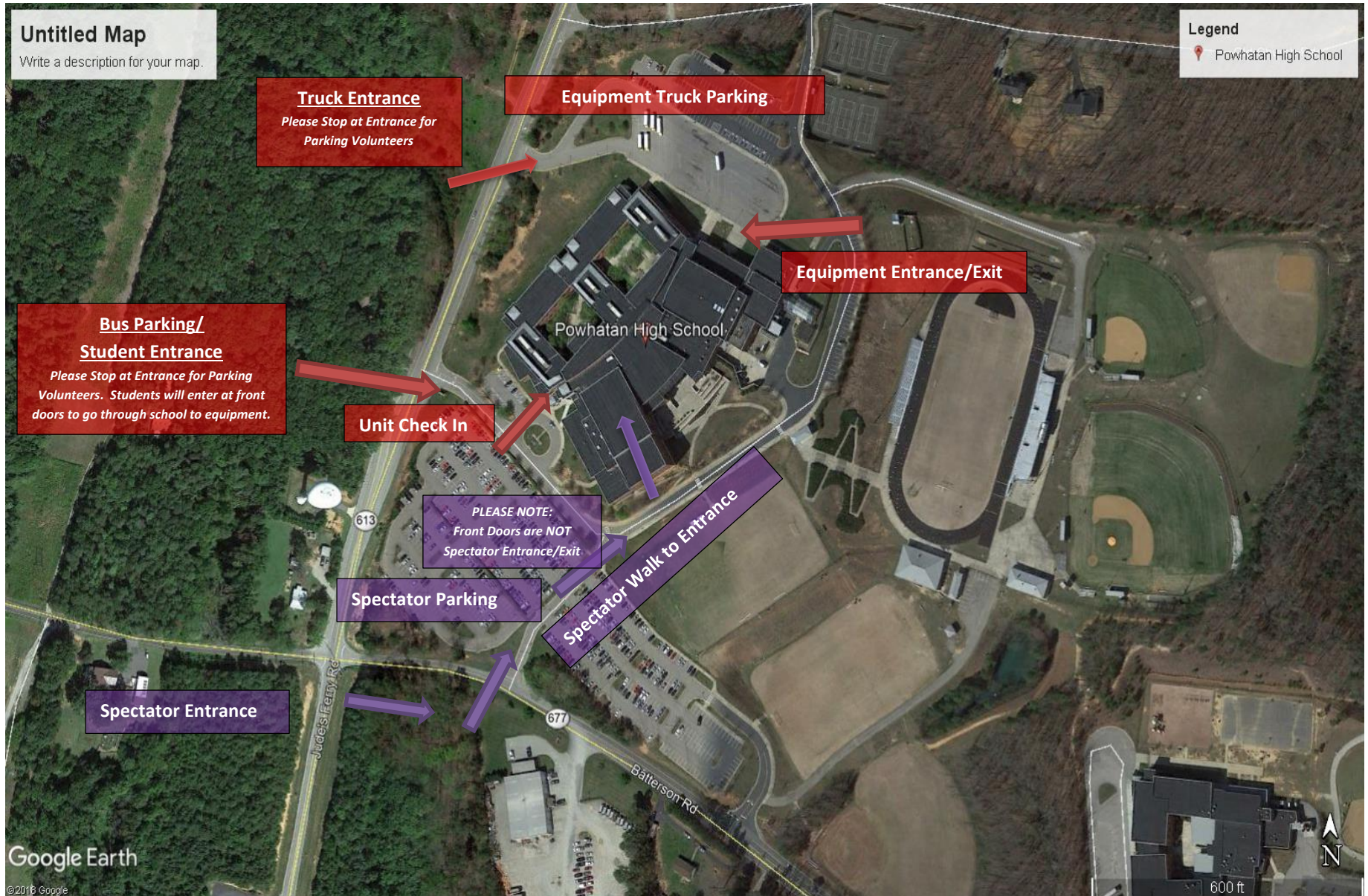

POWHATAN HIGH SCHOOL

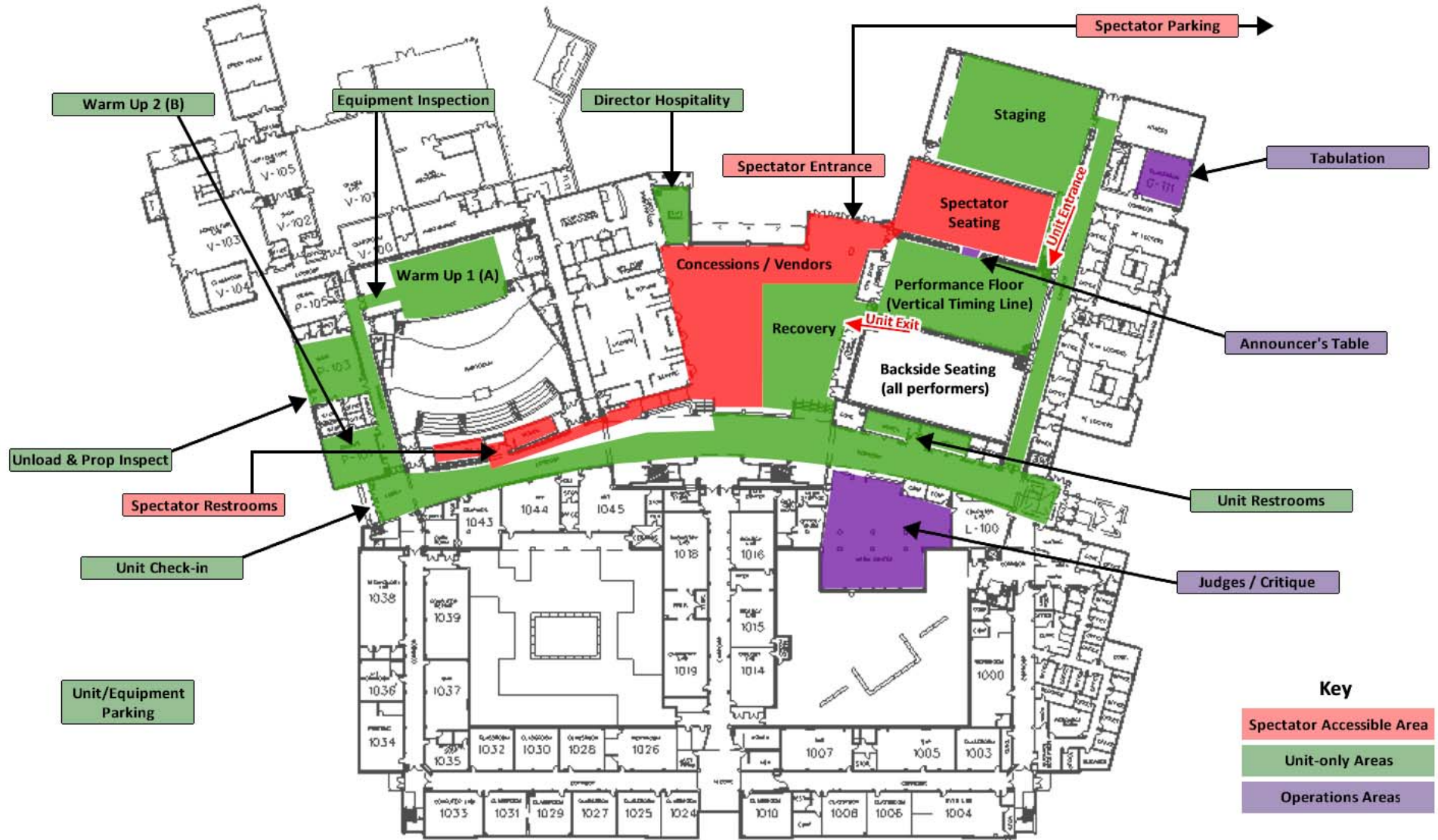



Richmond Regional Competition Area Powhatan High School, Powhatan, VA

All WGI contest sites must have a minimum of seventy by one hundred feet (70' x 100') to accommodate a "safety zone" of five (5) feet from any spectator seating. If no spectators are seated on the left and right sides, then the safety zone will be eliminated on the left and right sides of the competition area and extend to the wall.

The "competition area" at this event measures 70'X100'. All performing groups must be prepared to perform within that area. Floors (tarps) may not extend into the safety zones per rules found in the WGI Adjudication Manual and Rulebook

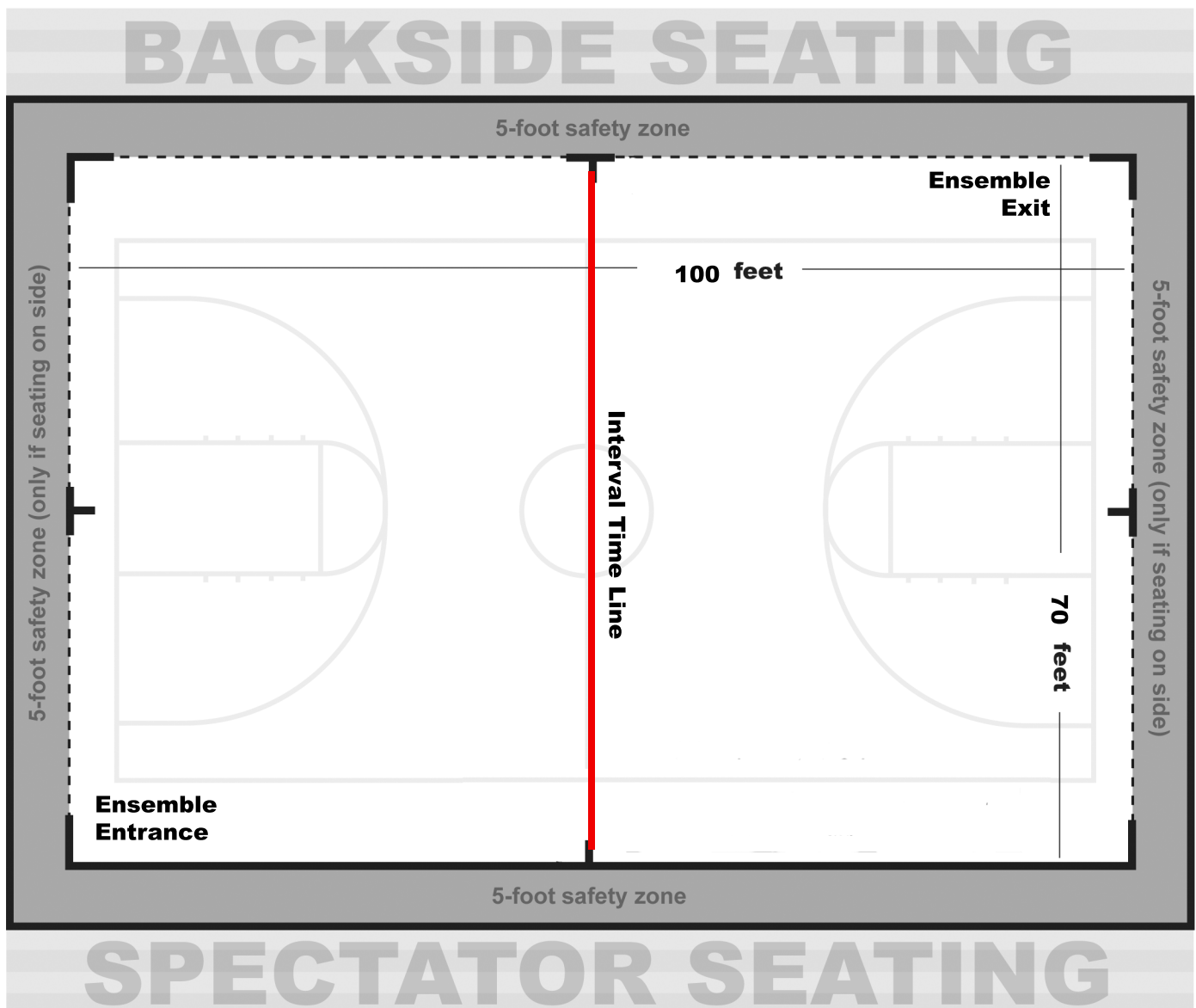

20^{WGI}
20^{I AM}



JOIN THE RICHMOND PERC/WINDS REGIONAL BAND!



- Free all-in-one group communication platform.
- Share group announcements via push notification, text message or email.
- Robust group calendar and membership management.
- Customizable to your unique communication needs.
- Available for your mobile device and desktop.

BAND LINK:

<https://band.us/n/a1ab21KaG7a8O>

1

Go to the Apple App Store or Google Play Store, search for BAND and download.

2

Sign up using your phone number, email, Facebook account or Google account.

3

Scan the QR code or use the link below to join the BAND.



#WGI2020

#IAMWGI