

2019 Austin Color Guard Regional Contest Information

Saturday and Sunday, March 2&3
Saturday Prelims—10 am
Sunday Finals—9:30 am

Facility

Rouse High School
1222 Raider Way
Leander, TX 78641

Emergency Contacts (day of show only)

Stephanie Bonebrake—817-781-7995
Jen Barton—864-494-4992
Jason Robb—936-662-7306

Ticket Prices/Info

Prelims—\$15
Finals—\$18
Combo—\$25

Master Card/Visa Accepted

Please contact the Event Partner ticket contact PRIOR to the show if you have any questions or have a special circumstance.

Regional Contact Info

Contest Administrator—Stephanie Bonebrake
817-781-7995
stephanie@wgi.org

General Info—Jen Barton
864-494-4992
Jen.barton1@gmail.com

Jason Robb
936-662-7306
Jason.robbs@leanderisd.org

Judges

Panels are available in this packet.

General Contest Info

TO LISTEN TO JUDGES COMMENTARY: Each director should be set up with an account through CompetitionSuite. This is the only way to receive judge's commentary for any WGI event. Instructions to do this are available [here](#).

SOUND CHECK: One hour prior to the start of the contest and during breaks at the discretion of the Contest Administrator. If you choose to use the new music upload feature available in CompetitionSuite, WGI suggests you still do a sound test. Information regarding music uploads is available in the Regional Reminders.

WARM-UP AREA: All maps are in this packet. Color guards should report one hour prior to performance time. If you wish to use music in warm up, please be prepared to bring your own sound system.

PRELIM SCORES: Posted in the cafeteria.

GROUP SUMMARY SHEETS: Available on CompetitionSuite.

FINALS: The finals schedule will be available on WGI.org after it has been determined. The SA Class is in ROUNDS for this regional.

All open and world class color guards must make qualifying score to progress to finals. Qualifying scores are listed in the regional reminders.

VIDEOS: No video cameras will be allowed in any contest venue and no authorized space will be provided for groups to record their performance. Any liability associated with unauthorized recordings will rest with the individual or organization making the recording. WGI does not condone, nor accept any liability for, any unauthorized recording during the event.

PLEASE NOTE: WGI enforces a **NO SMOKING** policy at all WGI Regionals, including practice facilities.

Don't forget to review the [Regional Reminders!](#)



Winter Guard International

2405 Crosspointe Drive, Dayton, OH 45342 Phone: 937-247-5919 Fax: 937-247-9212 Email: office@wgi.org <http://www.wgi.org>



WGI Austin Color Guard Regional Judge Panels

Prelims

	Equipment	Movement	Design Analysis	General Effect	
SRA	Tim Hudnall	Erin Brown	Kelsey Gleason	Phil Madden	Adam Sage
SA	Tim Hudnall	Erin Brown	Becca Anderson	Phil Madden	James Mahoney
IA	Tim Hudnall	Erin Brown	Kelsey Gleason	Phil Madden	Adam Sage
SO	James Mahoney	Becca Anderson	Kelsey Gleason	Phil Madden	Adam Sage
IO	James Mahoney	Becca Anderson	Kelsey Gleason	Phil Madden	Adam Sage
SW	Tim Hudnall	Becca Anderson	Kelsey Gleason	Phil Madden	James Mahoney
IW	Tim Hudnall	Becca Anderson	Kelsey Gleason	James Mahoney	Adam Sage

Finals

	Equipment	Movement	Design Analysis	General Effect	
SRA	Tim Hudnall	Erin Brown	Kelsey Gleason	James Mahoney	Adam Sage
SA	Tim Hudnall	Becca Anderson	Kelsey Gleason	James Mahoney	Adam Sage
IA	Tim Hudnall	Becca Anderson	Kelsey Gleason	Phil Madden	Adam Sage
SO	Tim Hudnall	Erin Brown	Kelsey Gleason	Phil Madden	Adam Sage
IO	Tim Hudnall	Erin Brown	Kelsey Gleason	Phil Madden	Adam Sage
SW	Tim Hudnall	Erin Brown	Becca Anderson	Phil Madden	James Mahoney
IW	James Mahoney	Erin Brown	Becca Anderson	Phil Madden	Adam Sage

T&P	Chris Tomsa
----------------	-------------

Lead Judge	Shirley Dorritie
-------------------	------------------



Accessing Judge Commentary

You must have already activated your Competition Suite Account Profile in order for you to be able to listen to WGI judge commentary.

From a Smart phone:

Download the Commentary app:

- Apple: <https://itunes.apple.com/us/app/competitionsuite-commentary/id594112091?ls=1&mt=8>
- Android: <https://play.google.com/store/apps/details?id=com.competitionsuite.commentary>

From the website:

1. Visit <http://competitionsuite.com/login/> and log in using the password you set up in your CompetitionSuite profile.
2. Click on "Performances" on the left side of the page under your group's name.
3. Click on the appropriate commentary file you'd like to download or listen to.

Support

If you have questions, feel free to contact support at help@competitionsuite.com.

WGI Austin Color Guard Regional Rouse High School



271

Bus/Truck/
Staff Parking

Color Guard
Check In

Guard Area

Spectator
Entrance

Prop Unload/
Load

Spectator Parking

Raider-Way

Google Earth

© 2018 Google



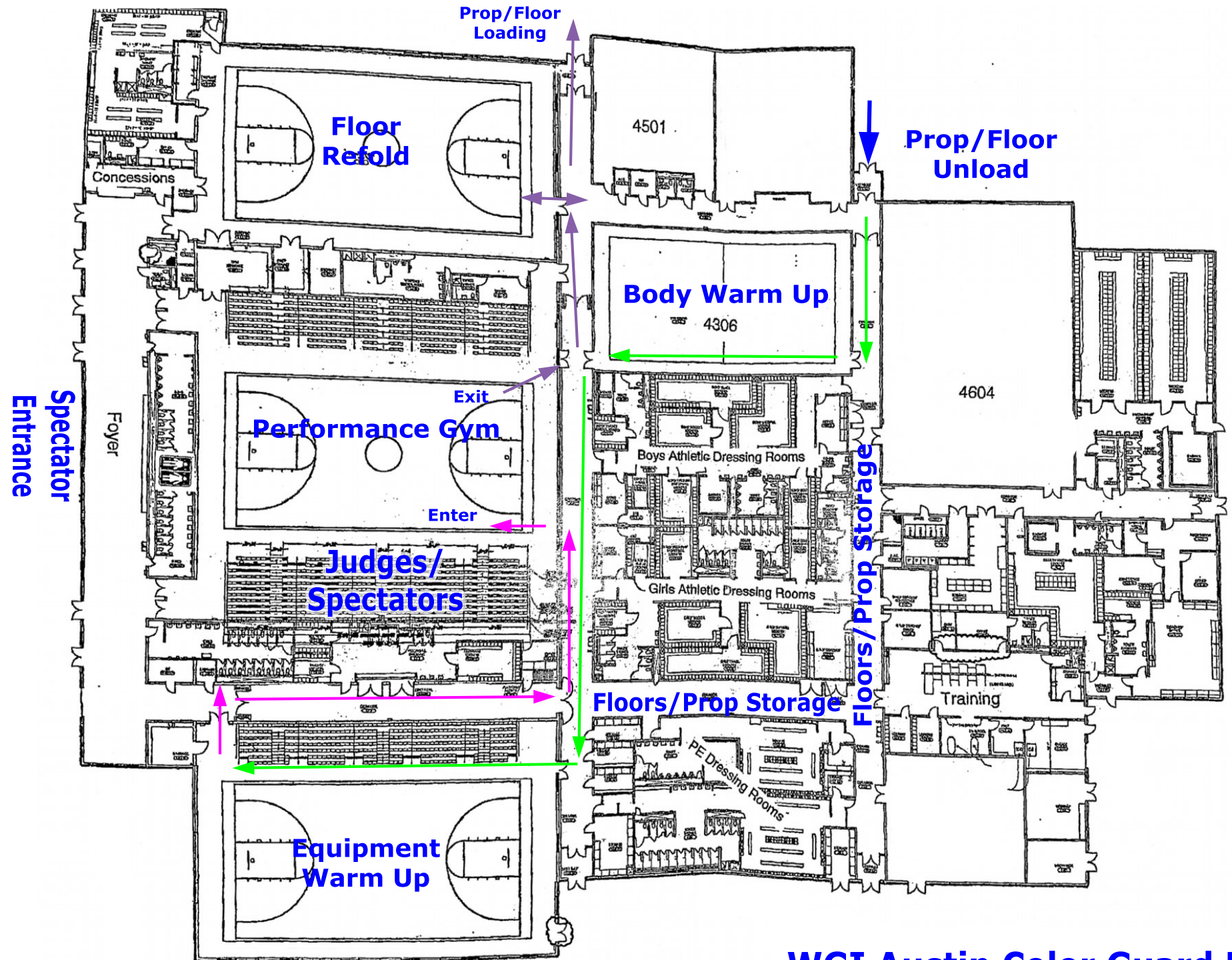

WGI Austin Color Guard Regional Rouse High School



WGI Austin Regional Competition Area Rouse High School, Leander, TX

All WGI contest sites must have a minimum of seventy by one hundred feet (70' x 100') to accommodate a "safety zone" of five (5) feet from any spectator seating. If no spectators are seated on the left and right sides, then the safety zone will be eliminated on the left and right sides of the competition area and can extend to a maximum of 106'X 78'.

The "competition area" at this event measures 100'X 72'. All performing groups must be prepared to perform within that area. Floors (tarps) may not extend into the safety zones per rules found in the WGI Adjudication Manual and Rulebook.

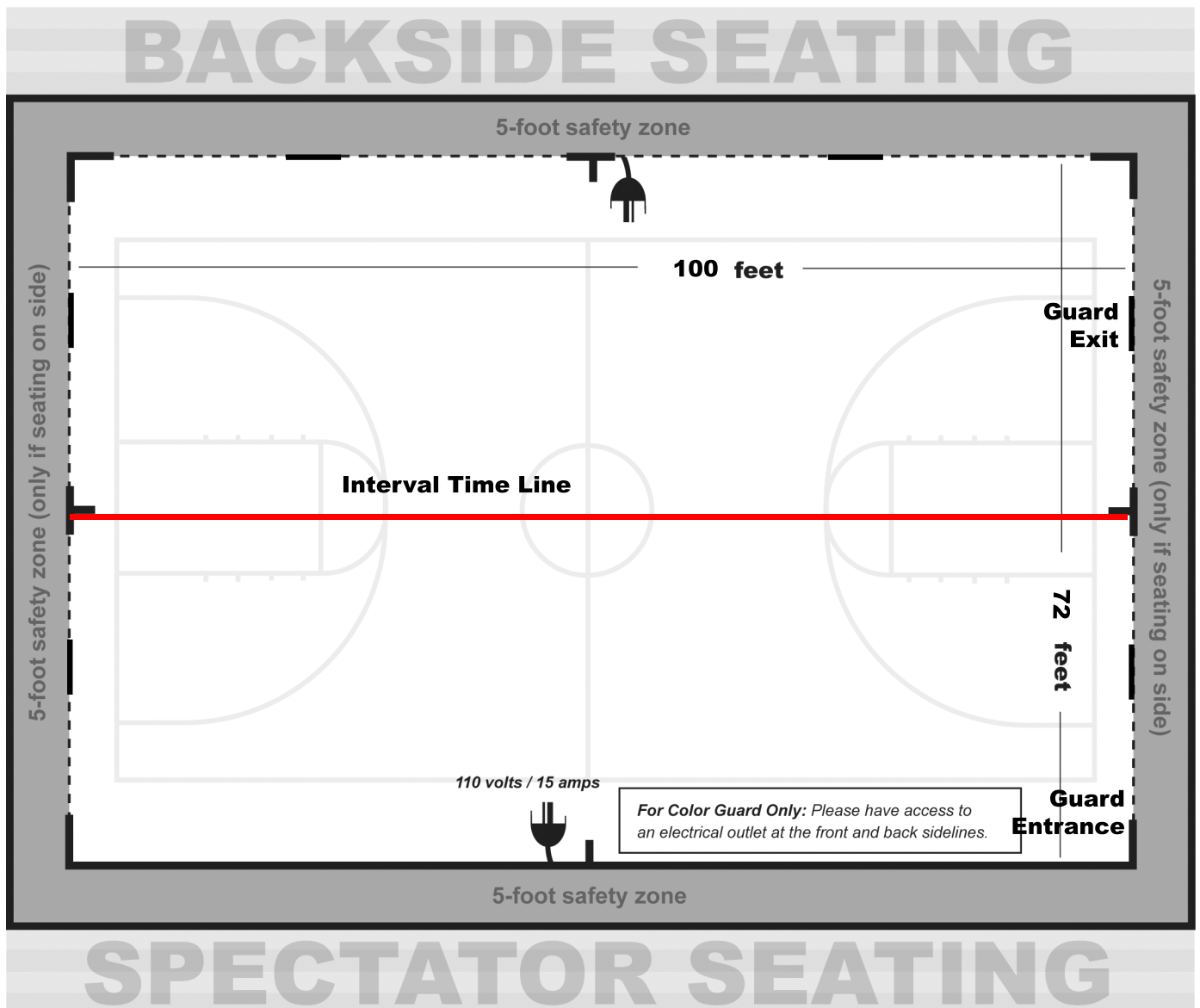

From the 2019 WGI Policy Manual

4.120 Sound Policy (Color Guard)

- All color guards should do a sound check at the designated times provided in the contest information packet to ensure the playability of any device or CD. Color guards should check the soundtrack at multiple places in the music to verify playability of any device
- Color guards should still do a sound check if they are using the WGI Music Upload in CompetitionSuite to ensure everything is correct.
- Color guard is responsible for providing the method that the music will be played, e.g. CD, MP3, computer, etc. Each color guard should have two methods to play their soundtrack in the event one does not work.
- Color guard must provide their music in a timely manner to the designated sound operator. Any delay in providing music is the responsibility of the color guard.
- Color guards using the Music Upload process through CompetitionSuite should have a backup using another device type such as an MP3 player, iPhone, or CD.
- Color guard must have a designated person at the sound table to operate any device provided to play music such as MP3 players or computers. Guard's representative is responsible to set up and play device. If a CD is provided, the color guard representative must instruct the sound operator as to what track or other relevant information is needed to start the music when directed by the contest Timing and Penalty judge or after the color guard's introduction.
- If the color guard has an issue with the music such as music is too soft, it begins in the wrong place or skips, the color guard's representative must make the decision to stop the music and tell the operator to stop the music. If the color guard representative chooses not to stop and the color guard completes their performance, the color guard will not be offered an opportunity to perform again.
- Interval timing will continue as the color guard resets and begins again. The Contest Administrator has the sole discretion in waiving any timing penalty due to the restart. If the stoppage is due to faulty sound equipment, operator error or an unexplained reason, overtime penalty may be waived.
- Issues related to the equipment provided by the color guard, quality of the CD or the color guard's representative error (using wrong playlist on MP3, etc.) will result in the actual interval timing being used and penalties, if any, being assessed.
- Volume direction must come from the color guard representative at the sound table. Direction will not be taken from the audience viewing area or across the floor. Final volume discretion is given to the sound operator based on their equipment and the Chief Judge who ultimately determines an appropriate volume level.
- The color guard representative may provide direction to the sound operator during the performance regarding equalization.
- It is the responsibility of the color guard to provide their music for each performance and to ensure that their soundtrack is working appropriately. CDs may not be left at sound table between performances.
- Under no circumstances will verbal abuse of the sound operator be tolerated. Penalties will be assessed per current WGI rules